

# ABSOLUTE LAND AUCTION

Hwy. 802/LaCenter Rd., LaCenter, KY

**31** Acres  
With Farmhouse & Barn  
in 7 Tracts & Combinations

APRIL						
S	M	T	W	T	F	S
			1	2	3	4
5	6	7	8	9	10	11
12	13	14	15	16	17	18
19	20	21	22	23	24	25
26	27	28	29	30		



Dale Harris  
Broker/Auctioneer

## HARRIS REAL ESTATE & AUCTION

3855 St. Rt. 45 North, Mayfield, KY 42066



Michael Harris  
Broker/Auctioneer

Visit our Website: [www.harrisauctions.com](http://www.harrisauctions.com)

*Your Professional Auctioneers*

FIRST CLASS  
U.S. POSTAGE  
PAID  
MAYFIELD, KY 42066  
PERMIT NO. 25

# Absolute LAND AUCTION

Hwy. 802/LaCenter Road, LaCenter, Kentucky

Directions: **From Wickliffe, KY** - Take KY 121/Court St. to KY 286. Follow KY 286 7.7 miles then turn on KY 802/LaCenter Rd. Proceed to property. **From Paducah, KY** - Take US 62 West 10.2 miles to KY 286. Follow KY 286 9 miles then turn on KY 802/LaCenter Rd. Proceed to property. *Signs Posted!!*



Tract #1



Tract #2

**31** Acres  
in 7 Tracts  
& Combinations



REAL ESTATE: 15% Down Day of Sale Balance in 30 Days. Make Inspections Prior To Day Of Sale, Buyer Will Be Required To Sign A Lead Based Paint Waiver. You May View The Property Anytime Prior To The Auction Date By Contacting The Selling Agents.

Information supplied is without any warranties or representations, either expressed or implied whatsoever, from Harris Auction, sellers or their respective representatives, agents or employees. Although all information in all advertisements is obtained from sources deemed reliable. All announcements day of sale takes precedence over printed material. Buyer will be required to sign a lead base paint waiver.

Real Estate Sells at 7:00PM  
at Ballard County Country Club  
2145 LaCenter Road (Hwy. 802)



# Absolute LAND AUCTION

Thursday, April 16th @ 7:00PM

**31** Acres  
in 7 Tracts  
& Combinations

Hwy. 802/LaCenter Road  
LaCenter, Kentucky

## Farmhouse & Barn Real Estate Tracts

**Tract #1** - 4.101 Acres w/Brick/Siding  
3 Bedroom, 2 Bath Farmhouse Featuring  
Kitchen, Living Room, Dining Room,  
& Enclosed Porch With Utility Area.

**Tract #2** - 3.708 Acres w/ A Livestock  
Barn and Well.

**Tract #3** - 2.800 Acres

**Tract #4** - 2.912 Acres

**Tract #5** - 6.683 Acres

**Tract #6** - 6.670 Acres

**Tract #7** - 3.977 Acres

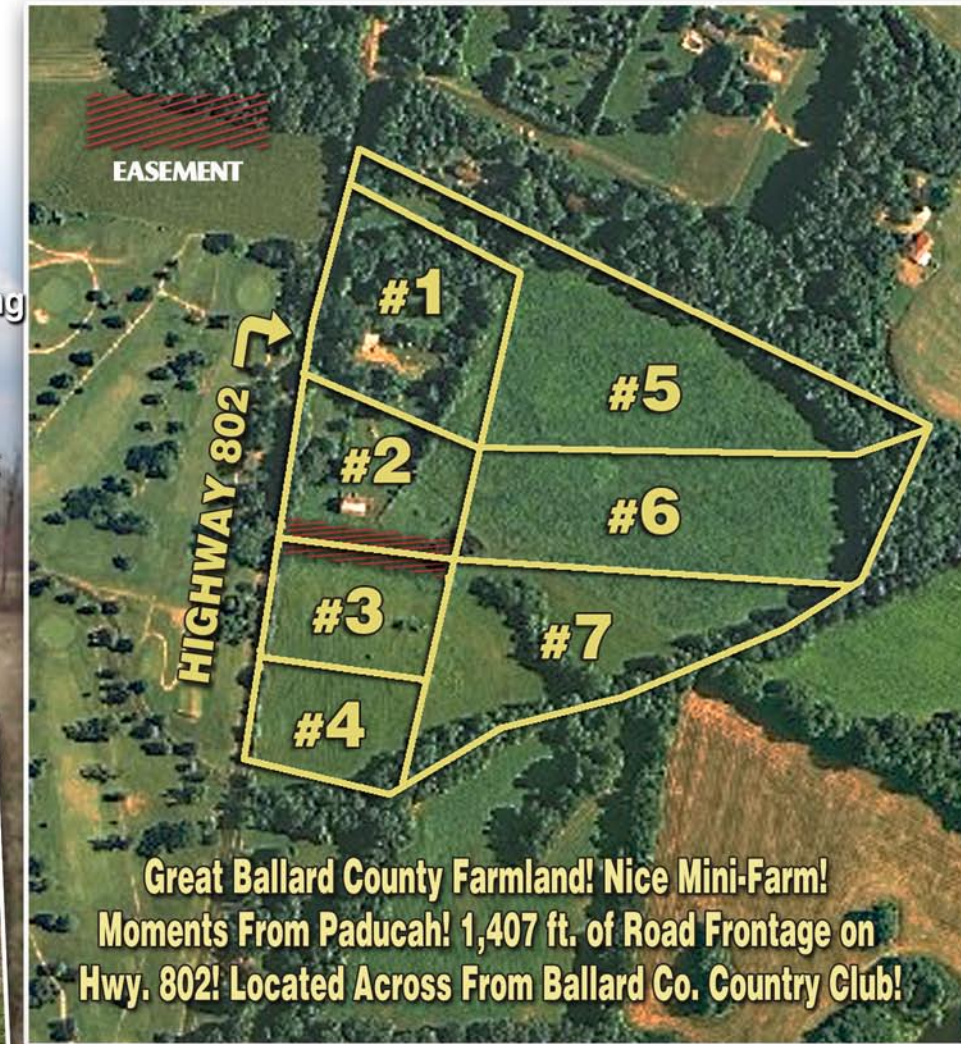

Great Ballard County Farmland! Nice Mini-Farm!  
Moments From Paducah! 1,407 ft. of Road Frontage on  
Hwy. 802! Located Across From Ballard Co. Country Club!

*Selling regardless of price to the highest bidder!!!*

Real Estate Sells At 7:00PM  
Auction Held at Ballard County  
Country Club Located at  
2145 LaCenter Road (Hwy. 802)

**HARRIS**  
REAL ESTATE & AUCTION  
2 Locations - Mayfield & Hopkinsville, KY

[www.harrisauctions.com](http://www.harrisauctions.com)